

AlcoHAWK[®] PRO FC

Owner's Manual

© 2017 Quest Products, Inc.
v01012017

TABLE OF CONTENTS

INTRODUCTION

EFFECTS OF ALCOHOL

PREPARATION

COMPONENTS DIAGRAM

OPERATION

READ THE RESULTS

ERROR MESSAGES

MENU OPTIONS

TEMPERATURE DISPLAY

PRINTING

PRECAUTIONS

SPECIFICATIONS

ACCESSORIES

CALIBRATION

WARRANTY

DISCLAIMER

INTRODUCTION

Intended Use

This Breath Alcohol Tester is intended to measure alcohol in human breath. Readings obtained by this device are used in the diagnosis of alcohol intoxication. The accuracy of this device has been established at a Blood Alcohol Concentration (BAC) of 0.008 and 0.032. Accuracy at a BAC greater than .032 has not been established.

Overview

This Tester provides a digital reading of a person's approximate BAC in seconds. The AlcoHAWK® PT750 is powered by a rechargeable lithium battery that in general lasts about 200 tests when fully charged. Please read the entire manual before use.

Effects of Alcohol

Variations among people and other factors, such as altitude and air temperature, affect the degree of intoxication. Some people may become intoxicated at low BAC levels. A low BAC on a breath alcohol tester does not mean that a person's reaction times can respond to any emergency encountered. You should not drink alcohol and drive or use any machinery after consuming alcohol. There is no safe way to drive under the influence of alcohol. Even one drink can make you unsafe.

Calibration

It is very important to have the instrument calibrated as recommended in this owner's manual (see Calibration, pg. 13). Failure to do so may result in readings that are inaccurate.

EFFECTS OF ALCOHOL

BAC	Dose-Specific Effects
0.020-0.039%	Generally no loss of coordination. Slight joy or loss of shyness. Depressant effects are not clear.
0.040-0.069%	General feelings of well-being, relaxation, shyness is reduced and sensation of warmth. Joy. Some minor impairment of reasoning and memory. Lowering of caution. Driving skills may be impaired.
0.070-0.099%	Slight impairment of balance, speech, vision, reaction time, and hearing. Joy. Judgment and self-control are reduced. Caution, reason and memory are impaired. Driving skills are always impaired.
0.100-0.129%	Major impairment of motor coordination and loss of good judgment. Speech may be slurred. Balance, vision, reaction time and hearing will be impaired. Joy.
0.130-0.159%	Gross motor impairment and lack of physical control. Blurred vision and major loss of balance. Joy reduced and state of feeling unwell begins to appear.
0.160-0.249%	Anxiety, restlessness predominates. Nausea may appear. Appearance of a "sloppy drunk."
0.250-0.299%	Needs assistance in walking. Total mental confusion. State of feeling unwell with nausea and some vomiting.
0.300-0.399%	Loss of consciousness.
0.400% +	Onset of coma. Possible death due to respiratory arrest.

Bailey, William J., *Drug Use in American Society*, 3rd ed., Minneapolis: Burgess, 1993.

DO NOT DRINK ALCOHOL AND DRIVE

**ALWAYS USE A DESIGNATED DRIVER
AFTER DRINKING ALCOHOL**

BE SAFE AND RESPONSIBLE

PREPARATION and COMPONENTS DIAGRAM

Insert a New Mouthpiece

Insert a new mouthpiece firmly into the top of the unit. It should be level when in place. See diagram below.



BATTERY REPLACEMENT

Apply a small amount of pressure on the battery cover located on the back of the unit and push down and away from the unit to release the cover. See the below diagram.

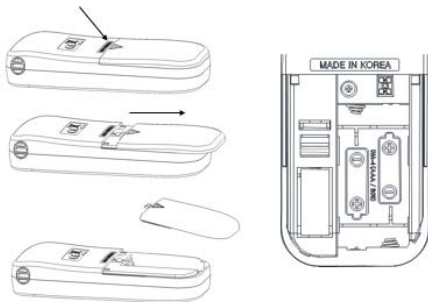

Make sure to insert the battery with the proper position of positive (+) and negative (-) as indicated.

Display

Test result is displayed to the 3rd decimal place at BAC.
Displayed numbers are decimal places.
Ex) 050 indicate 0.050

Measure unit is set to the region standard.



READY



BATT
LOW



WARN

Green LED will turn on when the device is ready for a test.
It will light up when the test result is below the warning level.

Yellow LED will flicker when the battery voltage is low.
Replace 1.5V Alkaline Batteries.

If the result is over 0.050%BAC the **WARN** LED will light up

OPERATION

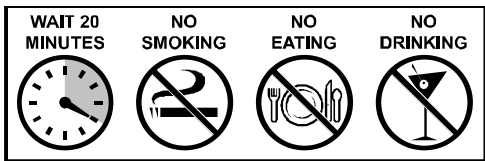

Wait 20 minutes after subject smokes, eats or drinks before testing. Failure to wait 20 minutes can give wrong BAC readings and damage the sensor.

1. Insert a mouthpiece into the mouthpiece inlet.
2. Push the ON/OFF power switch that is located in the right side under the display window.

- The unit will show “Full display” firstly and “on” along with a welcome sound. And then it starts

countdown which will be taken about 15 ~ 35 seconds. This warm-up process prepares the sensor

and circuit for testing.

3. When you hear a beep sound & “bLo” display is on, please blow steadily into the

mouthpiece until you would hear the “Beep” sound again. Stop blowing.

- In this stage, if you don't blow within 20 seconds, it automatically

turns off. Try to power on again.

4. After the circling line is on the display for 3 ~ 22 seconds, the test result will be

displayed for 20 seconds along with beep sound.

- If the test result is over 0.050%BAC(default setting) respectively, "WARN" signal (Red LED) will

light up along with "Alarm" sound.

- The result will be displayed for 20 seconds .(Result display along with "READY" or "WARN" LED on

for the first 15 seconds and LED off for another 5 seconds).

. If you push the power switch when the Green or Red LED is off, the unit goes back to countdown stage

for another test.

5. Finally, the unit will show "OFF" and turn off automatically along with a sound.

6. For the successive testing, try again from No.2 to No.4.

7. Space tests at least 2 minutes apart.





※ After using, you can turn the device off by pressing the power switch for 2 sec.

READ THE RESULTS

The result is an estimate of the subject's BAC. A breath alcohol tester cannot tell the exact BAC in the blood of the subject. A link between Breath Alcohol Content (BrAC) and BAC depends on many factors, such as temperature and health conditions. Only use this device to screen for the presence of alcohol.

Many people consider a 0.02% or greater a positive test for alcohol in "zero tolerance" screening. Most states have 0.08% as the legal BAC limit for tasks such as using a motor vehicle. Some states prohibit driving commercial vehicles or vessels with a 0.04% BAC or higher. Many states prosecute people for driving under the influence at any level.

ERROR MESSAGES

Error Message	Cause and Effect	Error Message	Cause and Effect
	If the result is higher than 0.050% BAC "WARN" signal is displayed along with "ALARM" sound.		The battery voltage is too low to perform a test. Replace 1.5V Alkaline Batteries.
	If the result is above 0.400% BAC, "Hot" signal is displayed along with alarm sound.		The user had a short exhale time during the test, which likely means the user did not exhale steadily and continuously for at least 3-5 seconds. Push the power button to perform another test.



Over 500 tests the unit shows "CAL".

Calibration is recommended. Consult to the seller or local distributor for the service.



When the ambient temperature is out of working temperature range (5°C ~ 40°C) the unit shows "OUT" and then turn off. Keep and use the unit within the recommended temperature range

PRECAUTIONS



1. After drinking, smoking and eating, users should wait at least 20 minutes before testing.
2. Avoid testing in strong winds, in a closed room with a heavy amount of smoke, or where alcohol is present.
3. When the "BAT" signal is on the display, it is advisable to replace 1.5V Alkaline Batteries.
4. Do not blow cigarette smoke, food or liquid into the unit.
5. Only use the unit in a temperature range of 10 - 40°C or 50 - 104°F. Operation above or below this range may affect the results.
6. BAC changes over time depending on many factors. BAC at one time can differ from BAC a few minutes later.
7. Do not use this product with an ignition interlock device or while inside a vehicle.
8. You cannot use the results of this product in court.
9. Do not use this device to determine if you or anyone else can operate any vehicle or machinery.
10. Do not let yourself or anyone else drink and drive. Always use a designated driver when you or anyone else drinks alcohol.
11. It is very important to have the instrument calibrated as recommended in this owner's manual (see Calibration). Failure to do so may result in readings that are inaccurate.

SPECIFICATIONS

Sensor	Smart Fuel Cell sensor
Accuracy	±0.005% BAC at 0.050% BAC
Detection Range	0.000 - 0.400% BAC
Warm-up Time	15 - 35 seconds
Response Time	3 - 22 seconds
Dimension	114mm x 47mm x 24mm
Weight	61.5g, (84g Battery included)
Power Supply	Two 1.5V "AAA" size Alkaline Batteries
Working Temp.	5 °C - 40 °C
Storage Temp.	0 °C - 40 °C
Calibration	Every 6 months or after 500 tests
Warranty	1 Year Limited Warranty

¹ Estimates, results may vary.

ACCESSORIES

Visit our online store at www.alcohawk.com to purchase:

- Mouthpieces
- Soft Carrying Pouch
- Hard Case

CALIBRATION

Calibration of the AlcoHAWK® PT750 occurs during manufacturing using advanced alcohol simulation equipment. The manufacturer passes known alcohol concentrations through the sensor to set baseline values for testing. During testing, the unit compares users' breath samples to these baseline values. If the verification determines that the BAC is not consistent with actual BAC levels, a technician calibrates the unit. The accuracy of breath alcohol testers can fluctuate after six to twelve months, depending on frequency of use and operating conditions. **We recommend sending the unit in for calibration after 200 tests have been performed, or every six to twelve months if less than 200 tests have been performed.**

If the unit is providing inconsistent results, unusually high or low readings, or no readings at all, a professional needs to recalibrate the unit.

For recalibration or support, please visit www.alcohawk.com or call 262-925-0970. During recalibration, a technician will perform a diagnostic check on the unit and reset the baseline sensor values.

ONE-YEAR LIMITED WARRANTY

Quest Products, Inc. (QUEST) warrants this unit to be free from defects in workmanship or material (excluding calibration) under normal use for ONE (1) YEAR from the date of retail purchase by the original buyer ("Warranty Period").

The warranty covers parts and labor on covered repairs and ground freight back to the customer (USA only). Except as provided above, QUEST provides this product "as is."

If a defect arises and QUEST receives a valid claim within the Warranty Period, at its option, QUEST will either (1) repair the product, (2) exchange the product with a product that is new or which has been built from new or serviceable used parts and functionally equivalent to the original product, or (3) refund the

purchase price of the product. If a refund is given, the returned product becomes QUEST's property. The warranty does not cover shipping to QUEST. The warranty is void if anyone tampers or abuses the unit.

This warranty is limited to the original consumer purchaser and can not be transferred to any other owner.

For warranty service please follow these instructions:

1. Call 262-925-0970 or email service@breathalyzers.com to obtain an RMA number. Return the unit postage paid, insured and in proper box.
2. You should obtain a proof of delivery receipt. You must pay the cost for shipping the unit to us.
3. You must enclose the following with the unit:
 - a. The completed RMA form (available at www.alcohawk.com)
 - b. Your name, return address and description of the problem. (No PO Box)
 - c. Your phone number to reach you during the day.
 - d. A copy of your sales receipt or invoice.

DISCLAIMER

QUEST makes no warranties, expressed or implied, as to the ability of this unit to determine whether, or to the extent to which, a test subject's mental or physical functionality, or judgment, is impaired by blood alcohol including whether the test subject is intoxicated, under any definition of that word. QUEST expressly disclaims any liability for incidental, special, or consequential damages of any nature under any legal theory. Any act or failure to act based upon a reading from this product is at the test subject's or user's own risk. QUEST assumes no responsibility for consequences to users or test subjects who use this product and are later under the influence of alcohol or to have had their judgment or any mental or bodily function

impaired by alcohol. Correlation between BrAC and BAC depends on many variables, such as temperature and health conditions of the test subject. A safe or low BAC reading does not mean that the test subject's physical or mental performance or judgment (including reaction times) can respond to any emergency encountered. A breath alcohol tester cannot determine the exact concentration of alcohol in the blood of a test subject.

QUEST does not warrant that the operation of the product will be error-free. QUEST is not responsible for any consequences arising from failure to follow instructions or relating to the product's use. This warranty does not apply: (a) to consequences caused by accident, abuse, tampering, misuse, flood, fire, earthquake or other external causes; (b) to consequences caused by operating the product outside the permitted or intended uses described by QUEST; (c) to consequences caused by service performed by anyone who is not a representative of QUEST or a QUEST Authorized Service Provider; or (d) to a product or part that has been modified to alter functionality or capability without the written permission of QUEST.

TO THE EXTENT PERMITTED BY LAW, THIS WARRANTY AND THE REMEDIES SET FORTH ABOVE ARE EXCLUSIVE AND IN LIEU OF ALL OTHER WARRANTIES, REMEDIES AND CONDITIONS, WHETHER ORAL OR WRITTEN, STATUTORY, EXPRESS OR IMPLIED. AS PERMITTED BY APPLICABLE LAW, QUEST SPECIFICALLY DISCLAIMS ANY AND ALL STATUTORY OR IMPLIED WARRANTIES, INCLUDING, WITHOUT LIMITATION, WARRANTIES OF MERCHANTABILITY AND FITNESS FOR A PARTICULAR PURPOSE AND WARRANTIES AGAINST HIDDEN OR LATENT DEFECTS. IF QUEST CANNOT LAWFULLY DISCLAIM STATUTORY OR IMPLIED WARRANTIES, THEN TO THE EXTENT PERMITTED BY LAW ALL SUCH WARRANTIES ARE LIMITED TO THE DURATION OF THE EXPRESS WARRANTY AND TO THE REPAIR OR REPLACEMENT SERVICE AS DETERMINED BY QUEST IN ITS SOLE DISCRETION.

QUEST does not authorize any QUEST reseller, agent, or employee to make any modification, extension, or addition to this warranty. If anyone determines any terms to be illegal or unenforceable, the legality or enforceability of the remaining terms shall not be affected or impaired.

EXCEPT AS PROVIDED IN THIS WARRANTY AND TO THE MAXIMUM EXTENT

PERMITTED BY LAW, QUEST IS NOT RESPONSIBLE FOR DIRECT, SPECIAL, INCIDENTAL OR CONSEQUENTIAL DAMAGES UNDER ANY LEGAL THEORY, INCLUDING BUT NOT LIMITED TO LOSS OF USE; LOSS OF REVENUE OR INCOME; LOSS OF ACTUAL OR ANTICIPATED PROFITS (INCLUDING LOSS OF PROFITS FROM A CONTRACT); LOSS OF THE USE OF MONEY; LOSS OF ANTICIPATED SAVINGS; LOSS OF BUSINESS; LOSS OF OPPORTUNITY; LOSS OF GOODWILL, OR LOSS OF REPUTATION.

Some countries, states and provinces do not allow the exclusion or limitation of incidental or consequential damages or allow limitations on how long an implied warranty or condition may last, so the above limitations or exclusions may not apply to you. This warranty gives you specific legal rights, and you may also have other rights that vary by country, state or province. This limited warranty is governed by and construed under the laws of the country where the product was purchased.

**DO NOT DRINK ALCOHOL AND DRIVE
ALWAYS USE A DESIGNATED DRIVER
AFTER DRINKING ALCOHOL
BE SAFE AND RESPONSIBLE**